

Heavy Hex Nuts

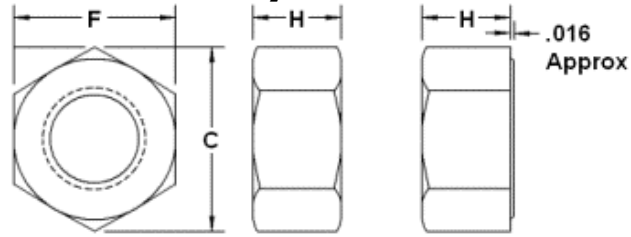

Heavy Pattern Nuts

SAE J995 Grade 2, ASTM A563

ASTM A194 GR. 2H Material: 1045 steel

Hardness 24-38

ASTM A194 GR. 4 Material: 4042 steel

ASTM A194 GR. 7 Material: 4140 steel

Note: You can upgrade from Grade 4 to Grade 7, but not vice versa.

Plain = NH020----

Plain = NH2H0----

Plain = NH400----

Plain = NH700----

Zinc = NH020----Z1

Zinc = NH2H0----Z1

Zinc = NH400----Z1

Zinc = NH700----Z1

Heavy Jam Pattern Nuts

SAE J995 Grade 2, ASTM A563

Plain = NHJ020----

Zinc = NHJ020----Z1

Nominal Size	F	C		H	Weight Per C	H	Heavy
	Width Across Flats	Width Across Corners		Thickness Hex Nut		Thickness Jam Nut	Weight Per C
	Basic	Max	Min		Basic		Basic
1/4	1/2	0.577	0.556	15/64	1.16	11/64	1.16
5/16	9/16	0.650	0.622	19/64	1.72	13/64	1.72
3/8	11/16	0.794	0.763	23/64	3.14	15/64	3.20
7/16	3/4	0.866	0.830	27/64	4.16	17/64	4.16
1/2	7/8	1.010	0.969	31/64	6.54	19/64	6.54
9/16	15/16	1.038	1.037	35/64	8.15	21/64	8.15
5/8	1 1/16	1.227	1.175	39/64	11.90	23/64	11.90
3/4	1 1/4	1.443	1.382	47/64	19.30	27/64	19.30
7/8	1 7/16	1.660	1.589	55/64	29.70	31/64	29.70
1	1 5/8	1.876	1.796	63/64	42.50	35/64	42.50
1-1/8	1 13/16	2.093	2.002	1 7/64	59.20	39/64	59.20
1-1/4	2	2.309	2.209	1 7/32	78.60	23/32	78.60
1-3/8	2 3/16	2.526	2.146	1 11/32	102	25/32	102
1-1/2	2 3/8	2.742	2.622	1 15/32	131	27/32	131
1-5/8	2 9/16	2.959	2.828	1 19/32	162	29/32	
1-3/4	2 3/4	3.175	3.035	1 23/32	204	31/32	204
1 7/8	2 15/16	3.392	3.242	1 27/32	241	1 1/32	
2	3 1/8	3.608	3.449	1 31/32	299	1 3/32	299
2 1/4	3 1/2	4.041	3.862	2 13/64	419	1 13/64	419
2 1/2	3 7/8	4.474	4.275	2 29/64	564	1 29/64	564
2 3/4	4 1/4	4.907	4.688	2 45/64	738	1 37/64	738
3	4 5/8	5.340	5.102	2 61/64	950	1 45/64	950
3 1/4	5	5.774	5.515	3 3/16		1 13/16	
3 1/2	5 3/8	6.207	5.928	3 7/16		1 15/16	1526
3 3/4	5 3/4	6.640	6.341	3 11/16		2 1/16	
4	6 1/8	7.073	6.755	3 15/16		2 3/16	

Dimensional specifications per ASME B18.2.1